



# iDSD Diablo 2

## Quick Set-Up



Set-Up video

\*MEMS ON/OFF

UnBAL 6.35mm output

Audio Format & kHz LED

Bluetooth Format LED

Analogue Volume Control

ON/OFF



Volume lock

BAL 4.4mm/\*MEMS output

Power Mode

Input mode selector

Pairing

USB-C input



BAL 4.4mm line input/output

USB-C 5V charging input

S/PDIF 3.5mm coaxial/optical input

Battery status LED

iEMatch switch

4.4  
Off  
6.35  
iEMatch

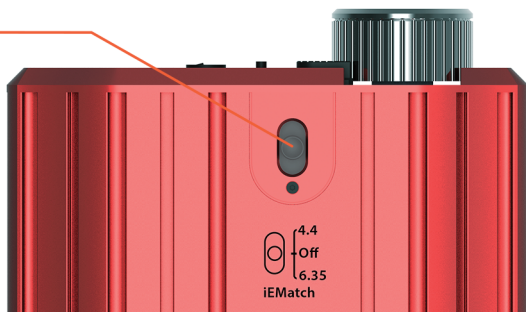

### 1 Power (5V only)

Battery status LED

- 76%-100%
- 21%-75%
- 11%-20%
- ☀ 0%-10%



### 2 Input

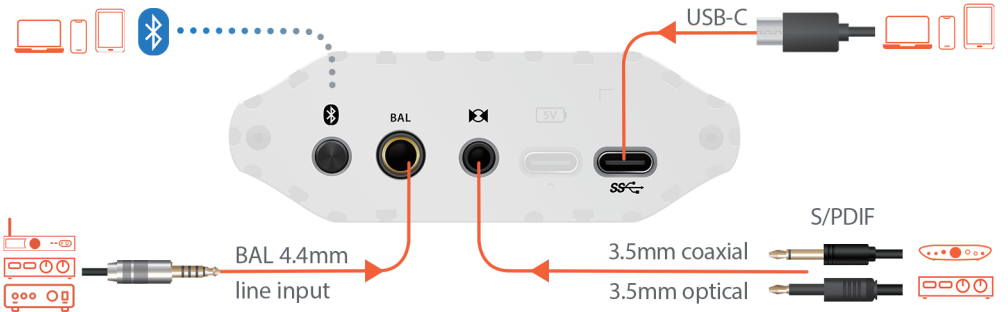

### 3 Output



#### 4 Input mode selector/Pairing

Short press to cycle through wired or Bluetooth input modes

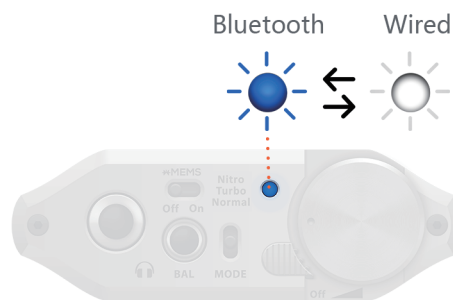

Long press ≥3 seconds to enter pairing mode

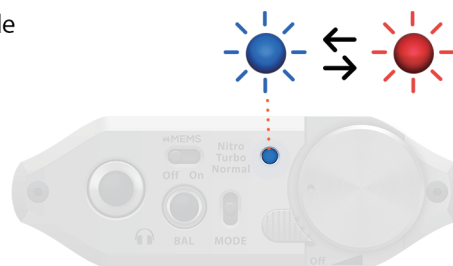

Pair your music source



Once connected

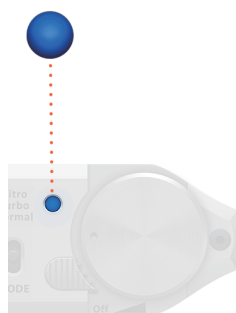

#### 5 Power Modes

Nitro  
Turbo  
Normal

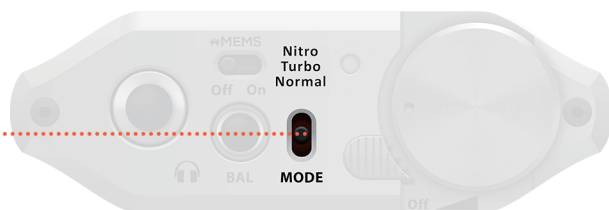

#### 7 xMEMS

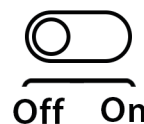

xMEMS Headphones



BAL 4.4mm



#### 8 Audio Format LED (kHz)/Bluetooth Format LED

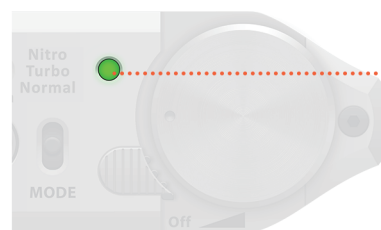

Bluetooth	Wired
SBC	OFF
AAC	PCM 44.1/48kHz
aptX Lossless	PCM 88.2~768kHz
LDAC	DSD 64/128
HWA/LHDC	DSD 256/512
aptX Adaptive	MQA
aptX	MQA Studio
aptX HD	Original Sample Rate/MQB

#### 9 Volume

Analogue volume

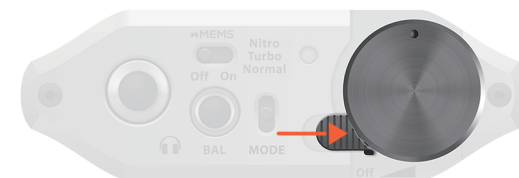

Slide to / volume